



# VAISHNO greens

Promoters :



## TRISHAKTI PROMOTERS & BUILDERS PVT. LTD.

300, Kharavela Nagar, Unit - III,  
Bhubaneswar - 751001, Odisha  
Tel : +91 9238384110, 9238384101/9238384102  
E-mail : trishaktibuilders@gmail.com  
www.trishaktibuilders.com

**ORERA REGISTRATION NO. : RP/19/2020/00397**



Architects :



**SAURASTRA DAS  
CONSULTANTS**  
300, Kharavel Nagar  
Bhubaneswar - 751 001  
Tel. : 0674 - 2392681

Designed & Printed at :



Plot No. M-29, KIIT Area, Near OTV  
Chandaka Industrial Estate  
Patia, Bhubaneswar - 751 024  
+91 674 2976825, +91 94371 62825  
artech.bbsr@gmail.com

The brochure is not a legal document. It has been produced for the general promotion of the development and for no other purpose. All information contained in this brochure is taken from design intent material and may be subject to further design development. These details do not form any part of any contract and whilst every effort has been made to ensure their accuracy, this cannot be guaranteed and intending purchasers should not rely on them as statements or representation of facts.



## GREEN IS PEACE OF MIND



# Imagination beyond boundaries!

A home is where the heart is. It is made up of not just bricks and concrete, but our dreams, fantasies, likes, and many cute little things that we treasure. That is why everyone will want their home to be a master piece, just like having a home in Vaishno Greens. Vaishno Greens located at Ogalpada, Southern Part of Bhubaneswar which is the future growth corridor of the city. The project is adjacent to NH-16 & before the IT SEZ - INFO VALLEY. Indeed, Vaishno Greens will be an address you can proudly flaunt.

TYPICAL FLOOR PLAN (BLOCK - A)

TYPICAL FLOOR PLAN (BLOCK - B)

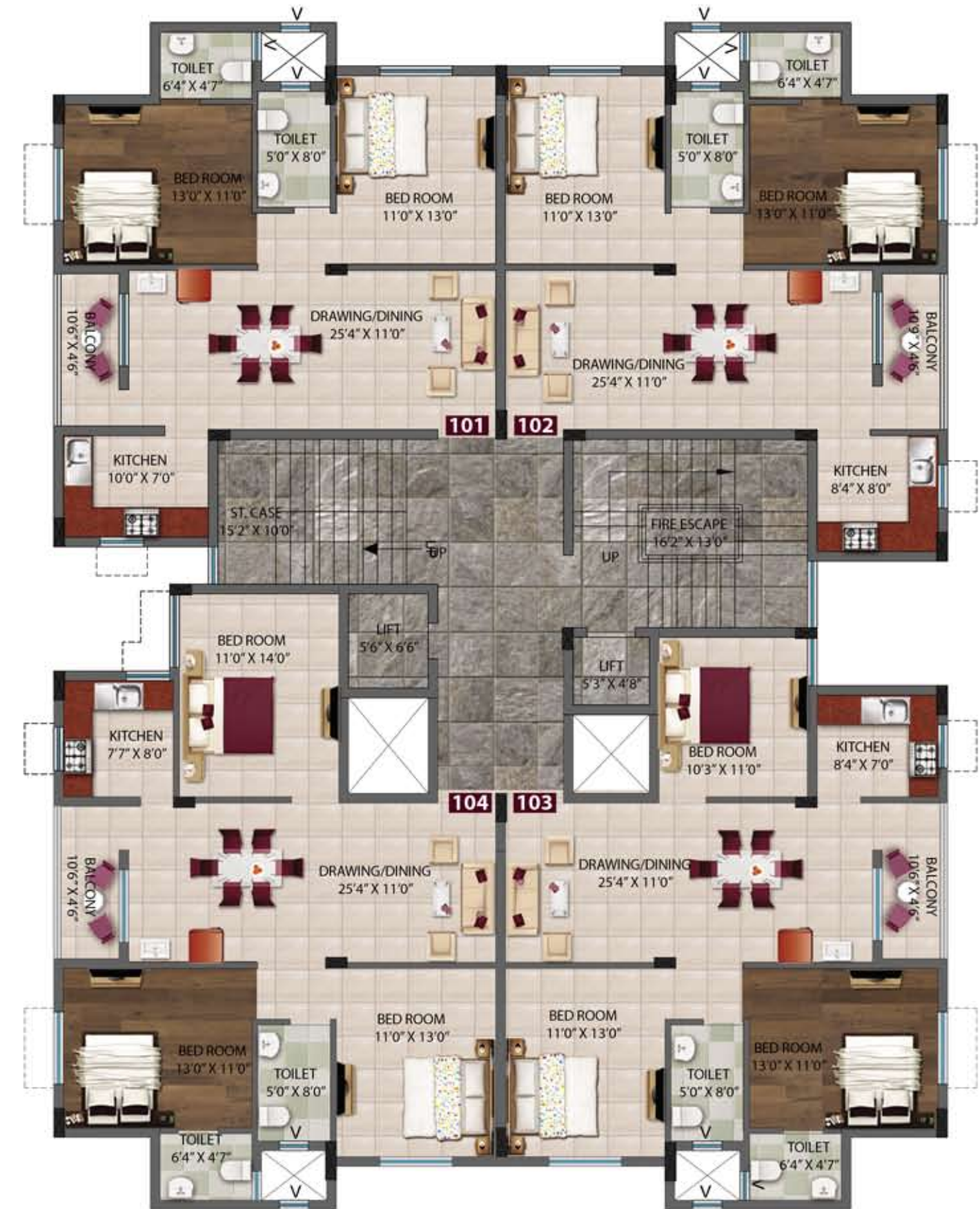

AREA STATEMENT

Flat No.	Type	Build-Up Area	Carpet Area	Balcony Area
101, 201, 301, 401, 501, 601	2BHK	1190 Sft.	69.98 Sqm	4.39 Sqm
102, 202, 302, 402, 502, 602	2BHK	1185 Sft.	69.66 Sqm	4.49 Sqm
103, 203, 303, 403, 503, 603	3BHK	1365 Sft.	80.24 Sqm	4.49 Sqm
104, 204, 304, 404, 504, 604	3BHK	1430 Sft.	84.16 Sqm	4.39 Sqm



AREA STATEMENT

Flat No.	Type	Build-Up Area	Carpet Area	Balcony Area
101, 201, 301, 401, 501, 601	2BHK	1190 Sft.	69.98 Sqm	4.39 Sqm
102, 202, 302, 402, 502, 602	2BHK	1185 Sft.	69.66 Sqm	4.49 Sqm
103, 203, 303, 403, 503, 603	3BHK	1365 Sft.	80.24 Sqm	4.49 Sqm
104, 204, 304, 404, 504, 604	3BHK	1430 Sft.	84.16 Sqm	4.39 Sqm



TYPICAL FLOOR PLAN (BLOCK - C)



AREA STATEMENT

Flat No.	Type	Build-Up Area	Carpet Area	Balcony Area
101, 201, 301, 401, 501, 601	3BHK	1466 Sft.	86.26 Sqm	4.39 Sqm
102, 202, 302, 402, 502, 602	2BHK	1136 Sft.	66.84 Sqm	4.77 Sqm
103, 203, 303, 403, 503, 603	2BHK	1176 Sft.	69.15 Sqm	4.49 Sqm
104, 204, 304, 404, 504, 604	3BHK	1485 Sft.	87.32 Sqm	4.39 Sqm



TYPICAL FLOOR PLAN (BLOCK - D)



AREA STATEMENT

Flat No.	Type	Build-Up Area	Carpet Area	Balcony Area
101, 201, 301, 401, 501, 601	3BHK	1470 Sft.	86.45 Sqm	4.39 Sqm
102, 202, 302, 402, 502, 602	3BHK	1512 Sft.	88.94 Sqm	4.39 Sqm
103, 203, 303, 403, 503, 603	2BHK	1164 Sft.	68.40 Sqm	4.49 Sqm



TYPICAL FLOOR PLAN (BLOCK - E)



AREA STATEMENT

Flat No.	Type	Build-Up Area	Carpet Area	Balcony Area
101, 201, 301, 401, 501, 601	3BHK	1444 Sft.	84.92 Sqm	4.39 Sqm
102, 202, 302, 402, 502, 602	2BHK	1212 Sft.	71.30 Sqm	4.49 Sqm
103, 203, 303, 403, 503, 603	3BHK	1512 Sft.	88.87 Sqm	4.39 Sqm
104, 204, 304, 404, 504, 604	3BHK	1485 Sft.	87.32 Sqm	4.39 Sqm



TYPICAL FLOOR PLAN (BLOCK - F)



AREA STATEMENT

Flat No.	Type	Build-Up Area	Carpet Area	Balcony Area
101, 201, 301, 401, 501, 601	3BHK	1451 Sft.	85.34 Sqm	4.39 Sqm
102, 202, 302, 402, 501, 601	3BHK	1474 Sft.	86.68 Sqm	4.39 Sqm
103, 203, 303, 403, 501, 601	3BHK	1572 Sft.	89.85 Sqm	4.39 Sqm



LAYOUT PLAN : 6 Blocks - 132 - 2BHK & 3BHK Flats



Fascination,  
beyond boundaries!



### SPECIFICATION

- Foundation : Isolated R.C.C. Footing
- Structure : Earthquake Resistant R.C.C. Frame
- Flooring : Vitrified Floor Tiles in Drawing/Dining & Bed Rooms.
- Doors : Both side decorative laminated flush doors fitted to WPC/Sal wood frames. Hardware & fittings in stainless steel.
- Windows : Painted Aluminium/UPVC Windows with MS Grills.
- Kitchen :
  - Wall : Ceramic Tiles 2' above working platform.
  - Flooring : Anti skid floor tiles.
  - Fittings : Granite working platform with stainless steel sink.
- Toilets :
  - Wall : Designer tiles up to 7' height.
  - Floorings : Anti-Skid tiles.
  - Fittings : Wash basin, WC/Commode of reputed mark & all taps and fittings with designer C.P. of reputed make.
- Wall Finish : Distemping over wall putty punning to interior walls & weather coat paint to exterior walls.

### LOCATION MAP

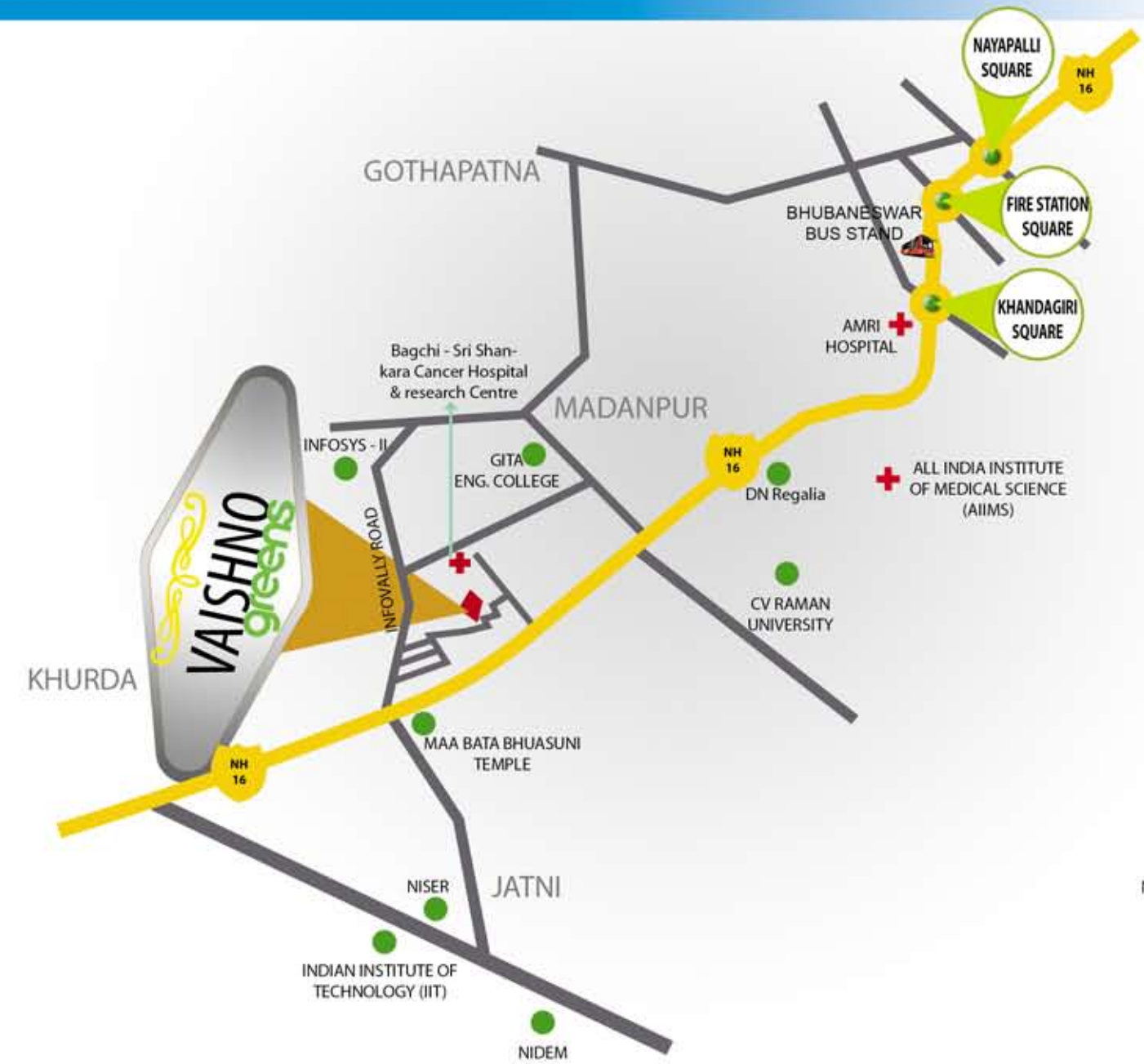

NOT TO SCALE

### PAYMENT SCHEDULE



- ▶ Booking Amount : 10%
- ▶ Execution of Agreements : 15%
- ▶ After Completion of Foundation : 15%
- ▶ After Completion of Roof Slab of Respective floor : 15%
- ▶ After Completion of Brick Work of Respective Flat : 15%
- ▶ After Completion of Plastering of Respective flat : 15%
- ▶ After Completion of Flooring of Respective Flat : 10%
- ▶ On or Before possession : 5%

## Indulge yourself at the **GYMNASIUM**

- ▶ Community hall to give you rich societal experience
- ▶ Gymnasium-with exercise stations
- ▶ An Indoor recreation centre decked with multiple games
- ▶ Large Landscaped area with multiple play station for Kids.
- ▶ Congregation place for Ladies & Senior Citizens.
- ▶ Jogging Track & Open Air Gym.



## Absolute Safety & Peace of **MIND**

- ▶ Gated and secured community
- ▶ High speed passenger elevators and service elevators in each tower
- ▶ 7-foot high wall encircles the compound with Green fencing upto 15' height.
- ▶ 24\*7 CCTV surveillance at strategic locations
- ▶ Intercom facility
- ▶ Power backup for essential common services & 300 W to each flat
- ▶ Advanced lightning arrestor
- ▶ Modern fire fighting facilities
- ▶ Sewerage treatment plant
- ▶ Rainwater harvesting
- ▶ Solar / Energy efficient lights in common area

