

## LOCATION MAP



**Developer :**  
A Joint Venture of



**TRISHAKTI**  
PROMOTERS & BUILDERS PVT. LTD.

Member of **CREDAI**

Flat No. 506, 5th Floor, Odysa Business Centre  
Rasulgarh, Bhubaneswar - 751010, Odisha  
Tel : +91 9238384101/102./110  
E-mail : trishaktibuilders@gmail.com  
www.trishaktibuilders.com

In association with :



**SAI KRUPA**  
BUILDERS & PROMOTERS

Member of **CREDAI**

Flat No. 201, 2nd Flor, Chanchala Awas,  
Cuttack Road, Jharpada, Bhubaneswar-751006  
Cell : 9937333344, 9437303643, 9937025857  
Email : ratikanta2004@gmail.com

&



**Crown Developer & Builder**

300, Kharavel Nagar, Unit - III,  
Bhubaneswar - 751001, Odisha  
Tel : +91 674 2392681, Cell : +91 937061396, 9437051990

**Architect :**



**SAURASTRA DAS**  
CONSULTANTS  
300, Kharavel Nagar  
Bhubaneswar - 751 001  
Tel. : 0674 - 2392681

**ORERA Registration No. : RP/19/2022/00832**

www.rera.odisha.gov.in

The brochure is not a legal document. It has been produced for the general promotion of the development and for no other purpose. All information contained in this brochure is taken from design intent material and may be subject to further design development. These details do not form any part of any contract and whilst every effort has been made to ensure their accuracy, this cannot be guaranteed and intending purchasers should not rely on them as statements or representation of facts.

# Chandaka Meadows

**BLOCK : C & E**

**Come Home to Nature ... ..  
A Pristine Life of Tranquillity**



# BLOCK - C



Flat No	Type	Build-Up Area	Carpet Area	Balcony Area
101,201,301,401,501,601,701	3BHK	1269 Sq.ft.	72.39 sqm	6.21 sqm
102,202,302,402,502,602,702	3BHK	1283 Sq.ft.	73.70 sqm	5.80 sqm
103,203,303,403,503,603,703	3BHK	1269 Sq.ft.	72.39 sqm	6.21 sqm
104,204,304,404,504,604,704	3BHK	1269 Sq.ft.	72.39 sqm	6.21 sqm
105,205,305,405,505,605,705	3BHK	1283 Sq.ft.	73.70 sqm	5.80 sqm
106,206,306,406,506,606,706	3BHK	1269 Sq.ft.	72.39 sqm	6.21 sqm

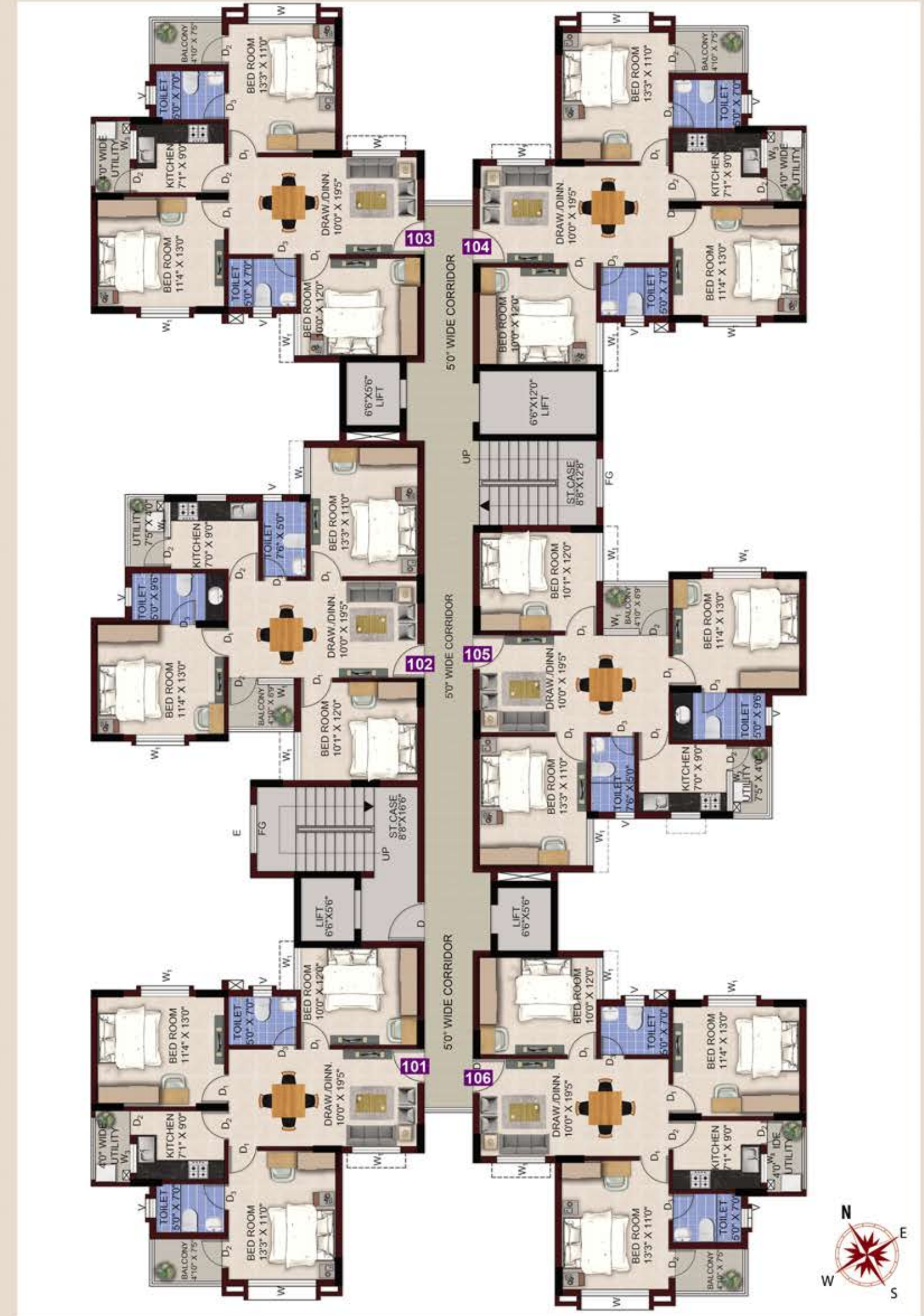

# BLOCK - E



Flat No	Type	Build-Up Area	Carpet Area	Balcony Area
101,201,301,401,501,601,701,801	3BHK	1262 Sq.ft.	72.58 sqm	5.62 sqm
102,202,302,402,502,602,702,802	3BHK	1256 Sq.ft.	72.23 sqm	5.62 sqm
103,203,303,403,503,603,703,803	3BHK	1256 Sq.ft.	72.23 sqm	5.62 sqm
104,204,304,404,504,604,704,804	3BHK	1256 Sq.ft.	72.23 sqm	5.62 sqm
105,205,305,405,505,605,705,805	3BHK	1262 Sq.ft.	72.58 sqm	5.62 sqm
106,206,306,406,506,606,706,806	3BHK	1262 Sq.ft.	72.58 sqm	5.62 sqm
107,207,307,407,507,607,707,807	3BHK	1256 Sq.ft.	72.23 sqm	5.62 sqm
108,208,308,408,508,608,708,808	3BHK	1256 Sq.ft.	72.23 sqm	5.62 sqm
109,209,309,409,509,609,709,809	3BHK	1256 Sq.ft.	72.23 sqm	5.62 sqm
110,210,310,410,510,610,710,810	3BHK	1262 Sq.ft.	72.58 sqm	5.62 sqm

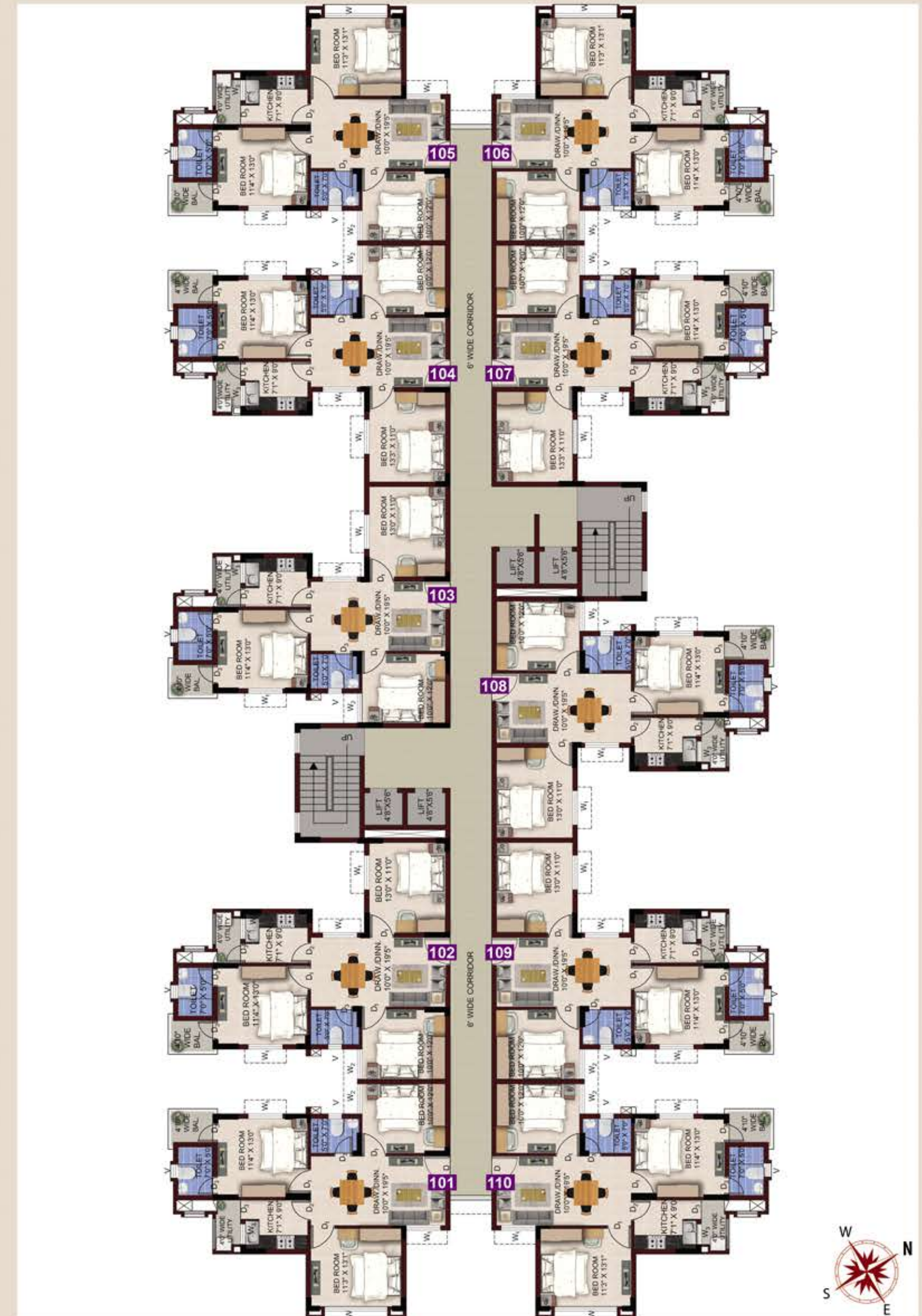

## SPECIFICATION

Foundation	: Isolated R.C.C. Footing
Structure	: Earthquake Resistant R.C.C. Frame
Flooring	: Vitrified Floor Tiles in Drawing/ Dining & Bed Rooms.
Doors	: Both side decorative laminated flush doors fitted to WPC/Sal wood frames. Hardware & fittings in stainless steel.
Windows	: Painted Aluminium / UPVC Windows with MS Grills.
Kitchen	:
Wall	: Ceramic Tiles 2' above working platform.
Flooring	: Anti skid floor tiles.
Fittings	: Granite working platform with stainless steel sink.
Toilets	:
Wall	: Designer tiles up to 7' height.
Floorings	: Anti-Skid tiles.
Fittings	: Wash basin, WC/Commode of reputed mark & all taps and fittings with designer C.P. of reputed make.
Wall Finish	: Distemping over wall putty punning to interior walls & weather coat paint to exterior walls.

## AMENITIES

- ▶ Community hall to give you rich societal experience
- ▶ Gymnasium-with exercise stations
- ▶ Children's Play Area
- ▶ Jogging Track
- ▶ Gated and secured community
- ▶ High speed passenger elevators and service elevators in each tower
- ▶ 24\*7 CCTV surveillance at strategic locations
- ▶ Power backup for essential common services
- ▶ Advanced lightning arrestor
- ▶ Modern fire fighting facilities
- ▶ Sewerage treatment plant
- ▶ Rainwater harvesting
- ▶ Solar / Energy efficient lights in common area

## LAYOUT PLAN



## PAYMENT SCHEDULE



▶ Booking Amount	:	10%
▶ Execution of Agreements	:	15%
▶ After Completion of Foundation	:	15%
▶ After Completion of Roof Slab of Respective floor	:	15%
▶ After Completion of Brick Work of Respective Flat	:	15%
▶ After Completion of Plastering of Respective flat	:	15%
▶ After Completion of Flooring of Respective Flat	:	10%
▶ On or Before possession	:	5%